

INSTALLATION GUIDE

This guide provides all the requested information for using and installing this product. Furthermore, this guide will help you to prevent any misuses or damages caused by a bad installation.

WARNING

FOR YOUR SECURITY, READ ALL THE FOLLOWING INFORMATION, THE USAGE SHOULD FOLLOW ITS CONCEPTION'S PURPOSES.



A MISUSED PRODUCT COULD LEAD TO INJURY FOR THE USER.



BAD INSTALLATION CAN INVOLVE RISKS FOR THE USER AND/OR THE SNOWMOBILE.



IN ANY TIME, ADOPT A CAREFUL APPROACH.

1. Parts List

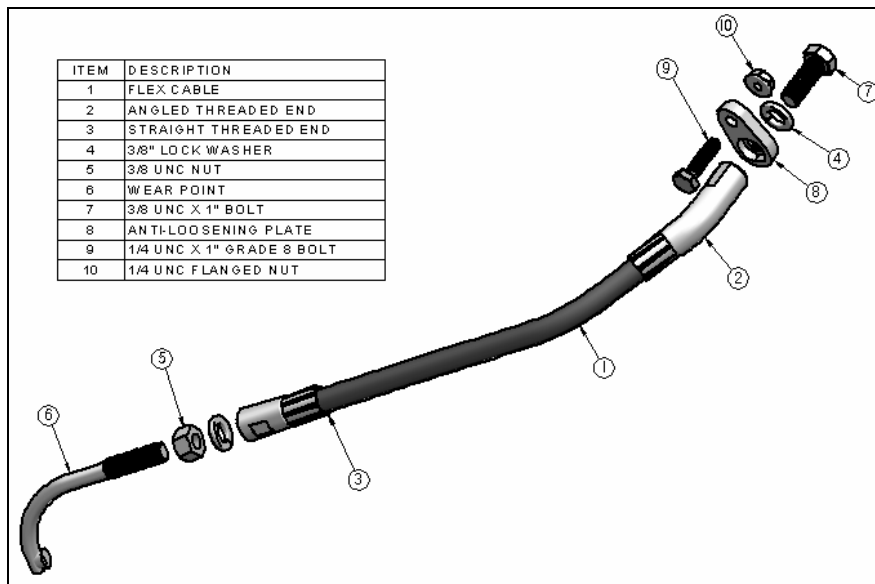

Figure 1

2. Installation

You can ask your dealer or your retailer to proceed to the installation of this product on your snowmobile or you can proceed yourself to this installation.

2.1 Mounting hole on the slide rail

You will have to locate or perforate a 3/8" hole on the side of the slide rail, at approximately 2.5 inches of the lower surface of the slide, as shown on Figure 2. This hole has to be located on the front half of the slide rail.

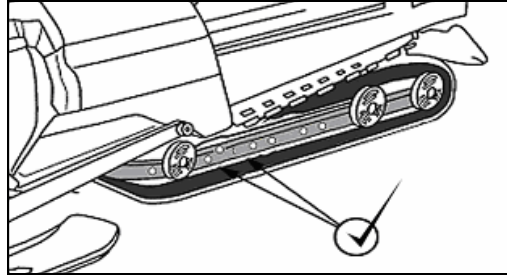

Figure 2

2.2 Anti-loosening plate mounting hole

First, slide the lock washer on the 3/8" bolt, *Item 7 of figure 1*, apply "red Loctite" on the threads and insert the bolt in the mounting hole from the inside of the rail, as shown in Figure 3. Then, put the anti-loosening plate and the angled end of the **TRAIL BLIZZER™**, *Items 2 and 8 of Figure 1*, on the threaded portion of the bolt and tighten the bolt to 35lb.ft. Make sure that the **TRAIL BLIZZER™** points 90 degree towards the ground as indicated to Figure 3.

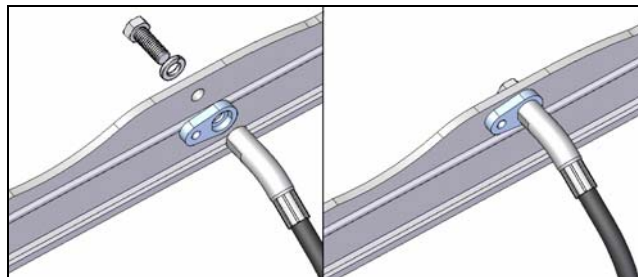

Figure 3

Once the assembly is positioned and fixed to the rail, use the second hole of the anti-loosening plate as a jig to drill the 1/4" mounting hole on the side of the rail.

3. Assembly

3.1 Anti-Loosening plate retaining bolt

Insert the 1/4 UNC bolt, *Item 9 of figure 1*, in the mounting hole with the bolt's head facing outwards, and tighten the nut, *Item 10 of figure 1*, as shown on figure 4.

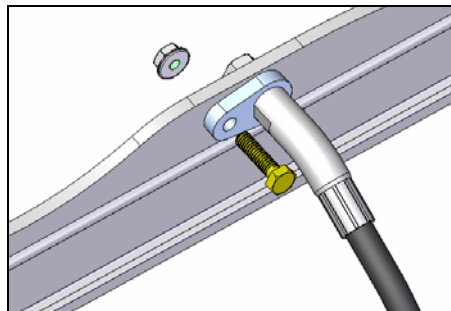

Figure 4

3.2 Wear Point

Turn the nut, *Item 5 of Figure 1*, freely on the threaded portion of the wear point, *Item 6 of Figure 1*, until it reaches the end of the threads. Then, insert the lock washer, *Item 4 of Figure 1*, on the threaded portion of the wear point and screw the assembly in the threaded opening of the **TRAIL BLIZZER™**. Hold the end of the **TRAIL BLIZZER™** with a 9/16" wrench and tighten the nut against the lock washer and the wear point as shown on Figure 5.

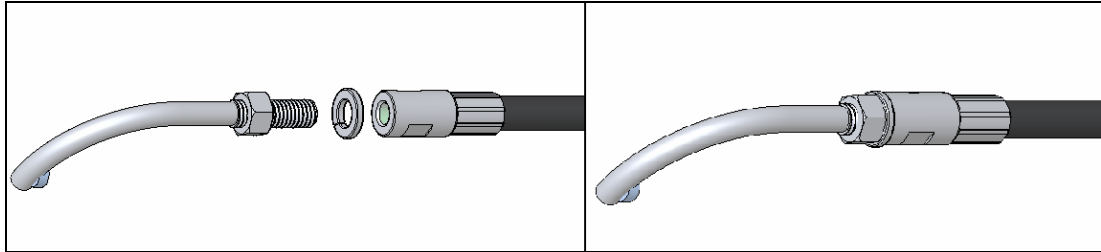

Figure 5

4. Installation Time

Installing the **TRAIL BLIZZER™** on both sides of a snowmobile requires approximately 30 minutes.

5. Required Tools

You will need the following tools in order to achieve the appropriate installation of this product.

- Ratchet socket set
- 1/4" and 3/8" sharp metal drill bit
- 9/16" and 7/16" wrenches
- Drill

6. Utilisation

Ensure that the assembly is securely mounted in order to hold-on on the road. The design of the **TRAIL BLIZZER™** enables it to allow a reverse motion of the snowmobile without breaking. The regular wear points and carbide wear points may be changed regularly. Carefully store aside your **TRAIL BLIZZER™** when they are unused, as shown in Figure 6.

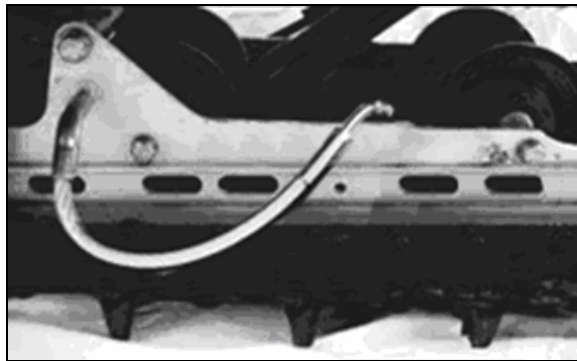

Figure 6

7. Contact

If you have any comment, question or information request regarding the **TRAIL BLIZZER™**, please use the following coordinates to contact us.



Qualipièces inc.
Canada J2C 0B9
www.qualipieces.com